



PRODUCT CATALOGUE



quality &
design

ABOUT THE COMPANY

ROSTEX VYŠKOV S.R.O., A CZECH MANUFACTURING COMPANY WITH A MORE THAN 90-YEAR TRADITION

In the time of its existence the ROSTEX brand has achieved a significant position on the domestic market, mostly thanks to its original technical solutions, its timeless designs, and its selection of the highest quality materials during production.

The philosophy of ROSTEX VYŠKOV s.r.o. is to offer the customer a product with high utility value.

Our main competitive advantages are:

- Tradition and experience
- In-house development and construction
- Top product quality
- Wide assortment of constructions and finishes
- Extensive network of sales locations in the Czech and Slovak Republic
- Manufacturing capabilities – option for customs production according to specifications

GUARANTEE

Selected finishes with a prolonged guarantee (5 years Cr-stainless steel satin and 10 years stainless steel)



CYLINDER PROTECTOR

- tested according to EN 1906
- security grades RC3 or RC4
- with drilling resistant ring
- firmly welded to the lockplate
- made from stainless steel



SYMBOLS

BB - key hole

PZ - cylinder hole

WC - toilet knob

 - resistant class 3

 - resistant class 4

DIN EN 179



escape route



- design with plastic fixing inserts



- design with fixing metal attachments



- designed for high traffic doors



- strenghten construction for greater loading



- designed for fire proof doors



- universal handle, for both door furniture and security fittings



- reversible mechanism (reversible spring)

DOOR HANDLES

- ECONOMY LINE SQUARE - DESIGN/H

- Material stainless steel
- Concealed steel under roses
- Classification acc. to EN 1906
- Stainless steel fasteners
- Door thickness 38-52 mm (WC version – door thickness 38-43 mm)
- Included reversible spring

Z DESIGN WITH FIXING METAL ATTACHMENTS

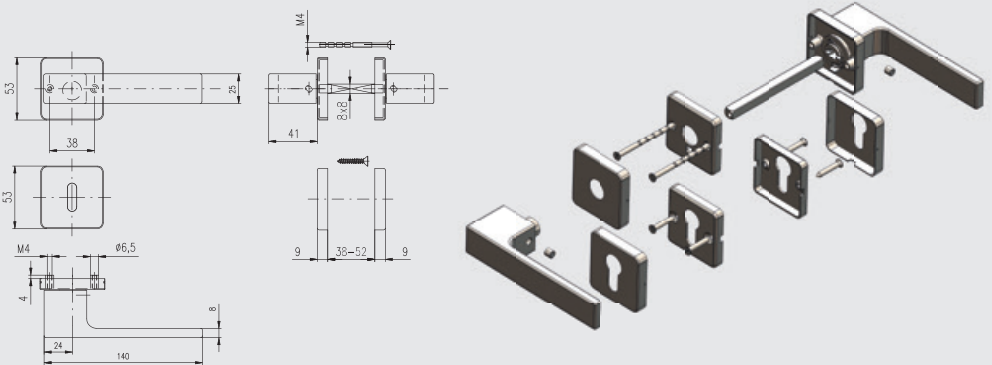

CASTELO/H

stainless steel satin



CASTELO/H

black (RAL 9005)



EMONT/H

stainless steel satin



EMONT/H

black (RAL 9005)



ECONOMY LINE

FONDI/H

    stainless steel satin



BB



PZ



WC



WC

FONDI/H

    black (RAL 9005)



BB



PZ



WC



WC

PORTO/H

    stainless steel satin



BB



PZ



WC



WC

PORTO/H

    black (RAL 9005)



BB



PZ



WC



WC

RAVENA/H

    stainless steel satin



BB



PZ



WC



WC

RAVENA/H

   anthracite (RAL 7016)



BB



PZ



WC



WC

RAVENA/H

    black (RAL 9005)



BB



PZ



WC



WC

ROSANO/H

   stainless steel satin



BB



PZ



WC



WC

SAVONA/H

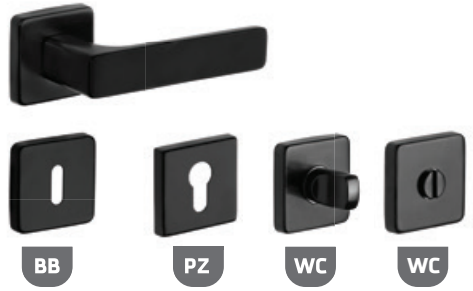

- ECONOMY LINE SQUARE - DESIGN/H LUMINO

- Lumino handles incorporate glass capillary filled with tritium gas
- Material stainless steel
- Concealed steel under roses
- Classification acc. to EN 1906
- Stainless steel fasteners
- Door thickness 38-52 mm (WC version – door thickness 38-43 mm)
- Included reversible spring
- Self-luminous lever handle
- Visible up to 15 m in the dark
- Maintenance-free, without external energy source
- 15 years of operational life
- Suitable for outdoor use

Z DESIGN WITH FIXING METAL ATTACHMENTS

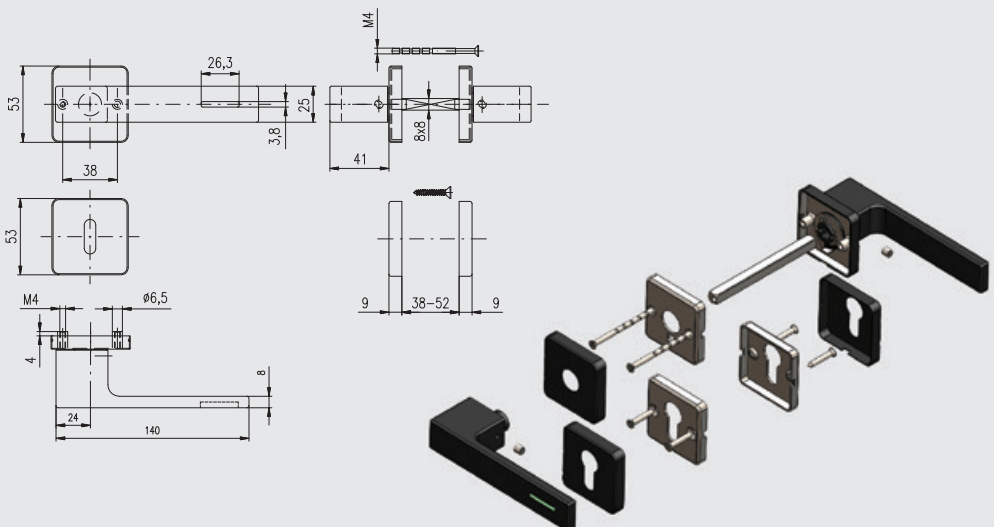

ECONOMY LINE

FONDI/H LUMINO

   black (RAL 9005)



RAVENA/H LUMINO

   black (RAL 9005)



FONDI/H LUMINO

   stainless steel satin



RAVENA/H LUMINO

   stainless steel satin



WC escutcheons DESIGN/H

- stainless steel, black, white, anthracite



Escutcheons DESIGN/H

- stainless steel satin, black, white, anthracite



K5 knob DESING/H

- stainless steel satin, black, white, anthracite



DOOR HANDLES

- ECONOMY LINE ROUND - DESIGN/N

- Material stainless steel
- Concealed steel under roses
- Classification acc. to EN 1906
- Stainless steel fasteners
- Door thickness 38-52 mm (WC version – door thickness 38-43 mm)
- Included reversible spring

Z DESIGN WITH FIXING METAL ATTACHMENTS

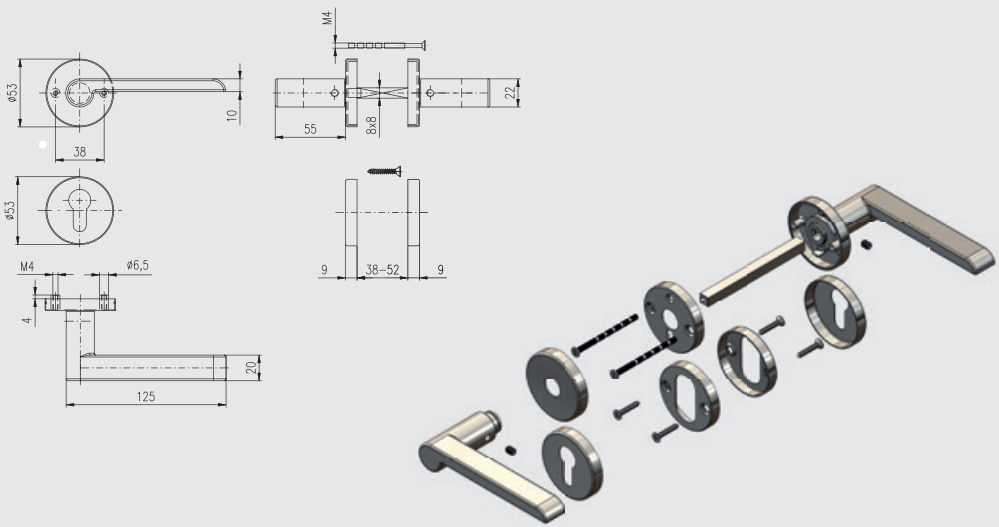

SOLDA/N

 **Z**  stainless steel satin



SOLDA/N

 **Z**  black (RAL 9005)



ECONOMY LINE

MESINA/N

   stainless steel satin



MESINA/N

   black (RAL 9005)



WC escutcheons round DESIGN/N
- stainless steel satin, black



K3 knob DESIGN/H
- stainless steel satin, black



Round escutcheons DESIGN/N -
- stainless steel satin, black



DOOR HANDLES ON ROUND ROSE

- Material stainless steel
- Concealed steel under roses
- Classification acc. to EN 1906
- Stainless steel fasteners
- Door thickness 38-52 mm (WC version – door thickness 38-43 mm)
- Included reversible spring

DESIGN WITH PLASTIC FIXING INSERTS

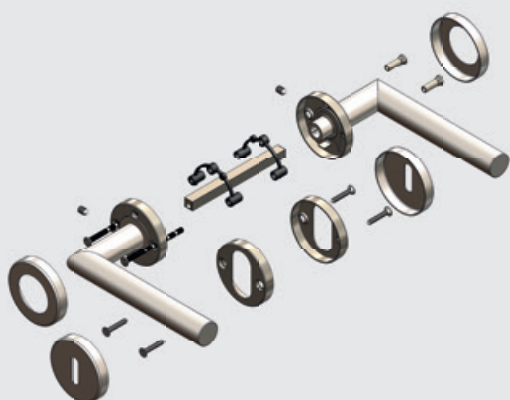
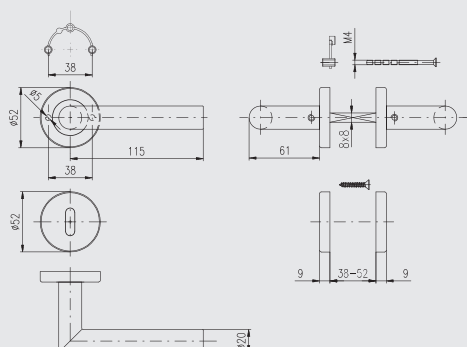

Z DESIGN WITH FIXING METAL ATTACHMENTS

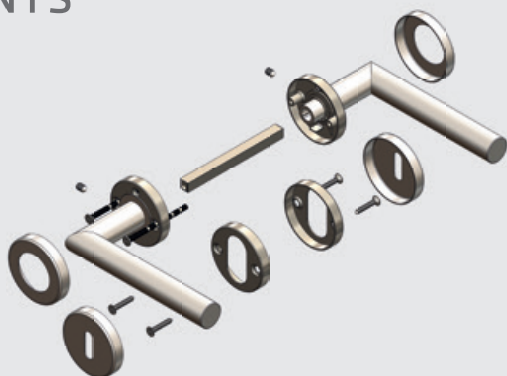
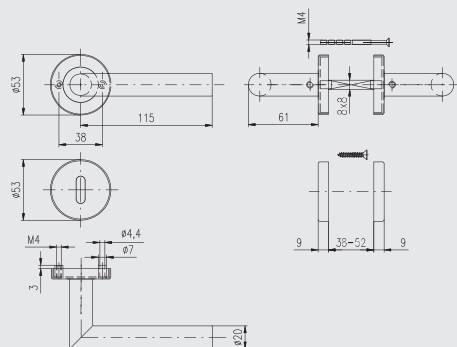

ALBACETE

  stainless steel satin



ALBACETE with metal bolts
for greater loading



BERGAMO

 stainless steel satin



BERGAMO with metal bolts



* section of the handle

ECONOMY LINE

BOLZANO with metal bolts

Z **3**  stainless steel satin



BB



PZ



WC



WC



CORNO with metal bolts

Z **3**   stainless steel satin



BB



PZ



WC



WC



CORTINA with metal bolts

Z **3**  stainless steel satin



BB



PZ



WC



WC



FERARA

 stainless steel satin



BB



PZ



WC



WC



MILANO with metal bolts

Z **3**   stainless steel satin



BB



PZ



WC



WC



NAPOLI

  stainless steel satin



BB



PZ



WC



WC



* section of the handle

PALERMO with metal bolts

Z **3**  stainless steel satin



PARMA

 stainless steel satin



VERONA with metal bolts

Z **3**  stainless steel satin



VIGO

  stainless steel satin



VIGO with metal bolts

Z **3**   stainless steel satin



* section of the handle

ECONOMY LINE

WC escutcheons round
- stainless steel satin

Round escutcheons
- stainless steel satin



K1 ball knob

K6 Knob on
rose – moving

K8 knob-knob option
– fixed or moving

K2 round
knob

DOOR HANDLES ON SQUARE ROSE

- Material stainless steel
- Concealed steel under roses
- Classification acc. to EN 1906
- Stainless steel fasteners
- Door thickness 38-52 mm (WC version – door thickness 38-43 mm)
- Included reversible spring

DESIGN WITH PLASTIC FIXING INSERTS

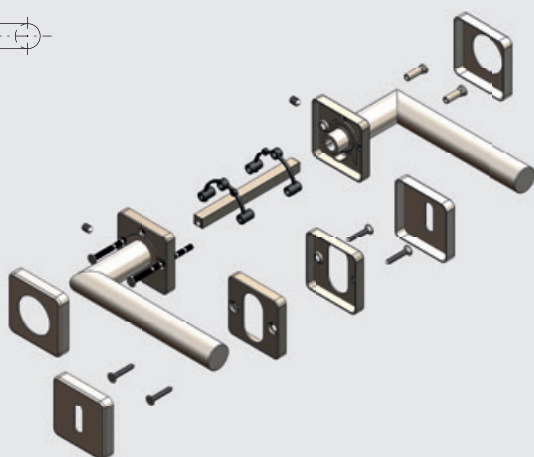
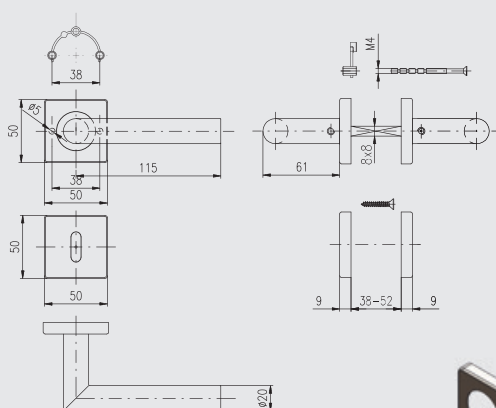

BOLOGNA/H

  stainless steel satin



BB



PZ



WC



WC



MANDELO/H

  stainless steel satin



BB



PZ



WC



WC



MARSIA/H

 stainless steel satin



BB



PZ



WC



WC



MILANO/H

  stainless steel satin



BB



PZ



WC



WC



PARMA/H

 stainless steel satin



BB



PZ



WC



WC



TORINO/H

 stainless steel satin



BB



PZ



WC



WC



* section of the handle

ECONOMY LINE

TREVISIO/H

  stainless steel satin



BB



PZ



WC



WC



VIGO/H

  stainless steel satin



BB



PZ



WC



WC



WC pair of escutcheons
- stainless steel satin



Square escutcheons
- stainless steel
satin



K4 knob on rose
- stainless steel
satin



DOOR HANDLES

OVAL

- Material stainless steel
- Concealed steel under roses
- Classification acc. to EN 1906
- Stainless steel fasteners
- Door thickness 38-52 mm
- Included reversible spring

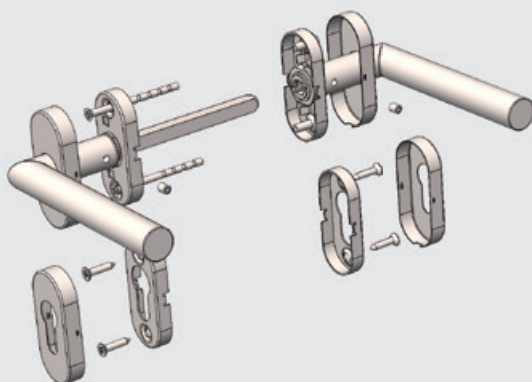
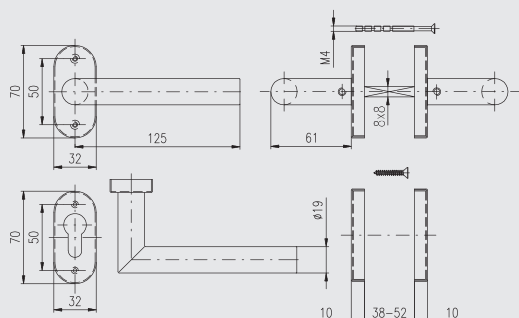

* section of the handle

ROSTEX

ALBACETTE

 stainless steel satin



BB



PZ



WC

VIGO

 stainless steel satin



BB



PZ



WC

Knob oval



SIGN PLATES

circular, self-adhesive, size: Ø75 mm



SIGN PLATES

rectangular, self-adhesive, size: 80x80 mm



DOOR STOPPER K1

size: Ø30 mm



SLIDING DOOR HANDLES FLUSH PULL HANDLES

CIRCULAR stainless steel satin, black

size: Ø50 mm

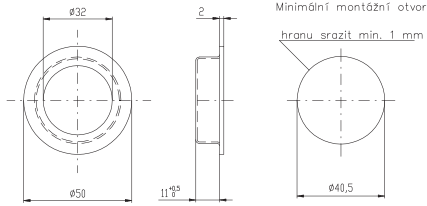

OVAL

stainless steel satin, black

size: 120 mm

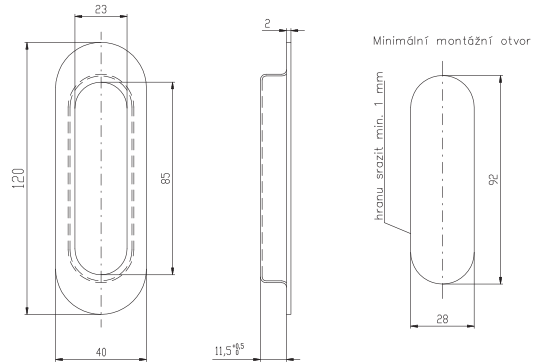

RECTANGULAR

stainless steel satin, black

size: 120 mm

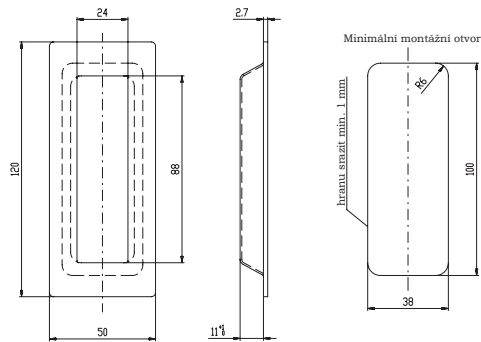

RECTANGULAR

stainless steel satin, black

size: 150 mm

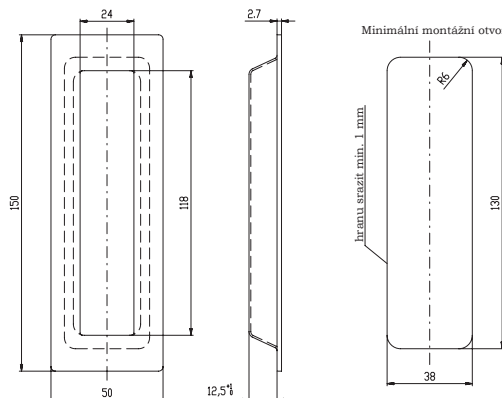

DOOR HANDLES

EXCLUSIVE

handle-handle
stainless steel
satin



handle-knob



804

handle-handle
stainless steel
satin



handle-knob



BRIT

stainless steel
satin



knob design



MONET

stainless steel
satin



knob design



DOOR HANDLES - ON PLATES, ON ROSE

TEMPO

stainless steel
satin



MONZUN

stainless steel
satin



SURIVAL/30

stainless steel
satin



SURIVAL/46

stainless steel
satin



BRIT/SNH

stainless steel satin



EXCLUSIVE/SNH

stainless steel satin



PULL HANDLES

PULL HANDLE ALFA - stainless steel satin, black

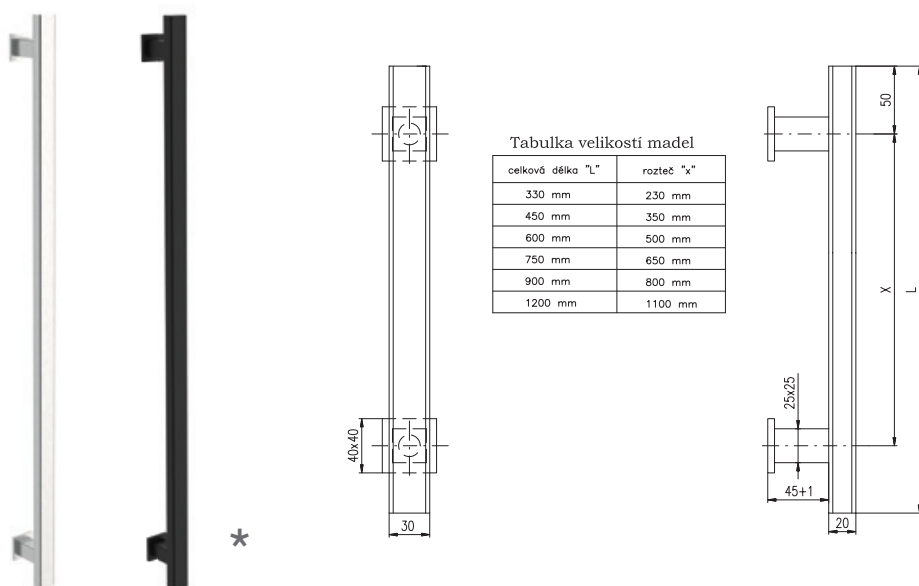

Door pull is designed to be mounted on the door using screws M6. Suitable for outdoor use. Assembly material depends on mounting options below and it is not included. Available in stainless steel satin or in RAL variant acc. the sample book (page 47).

Single mounting
under 50 mm - 5088000000
over 50 mm - 5088010000

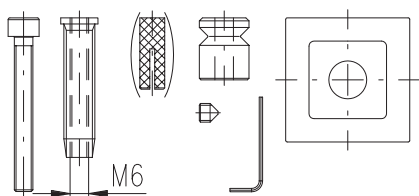

Back to back mounting
5588020000

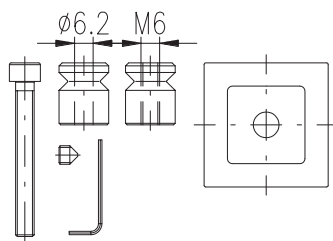

Single mounting – glass door
5588030000

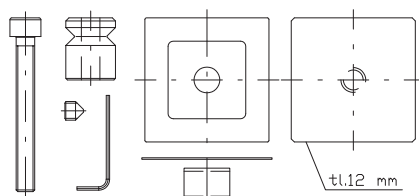

Back to back mounting – glass door
5588040000

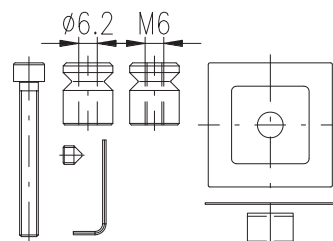

Available in stainless steel satin or in RAL variant acc. the sample book (page 47)

PULL HANDLE BETA - stainless steel satin

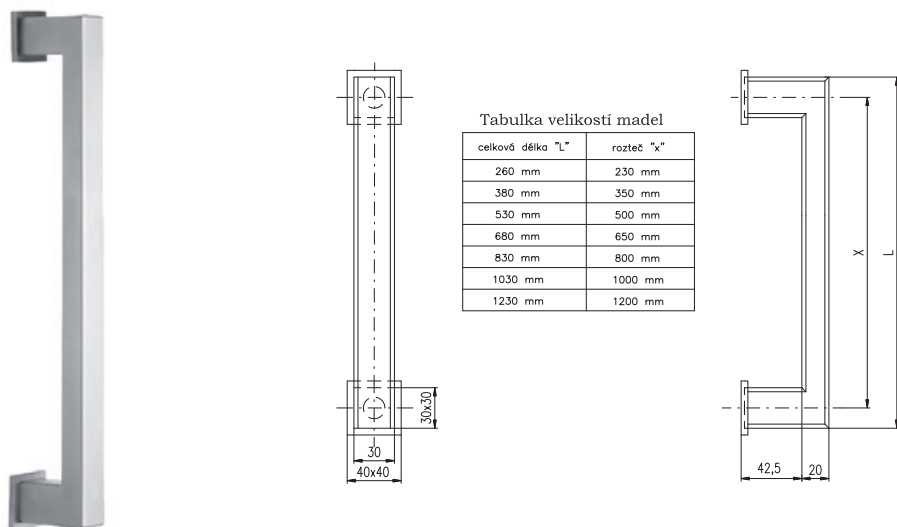

Door pull is designed to be mounted on the door using screws M6. Suitable for outdoor use. Assembly material depends on mounting options below nad it is not included. Available in stainless steel satin or in RAL variant acc. the sample book (page 47).

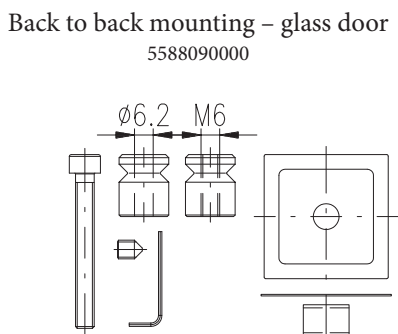
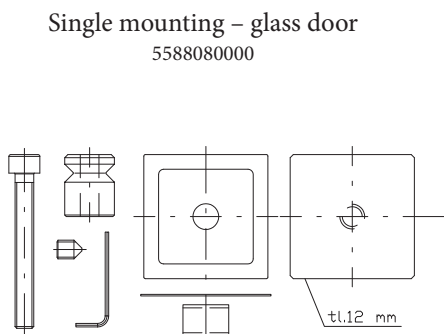
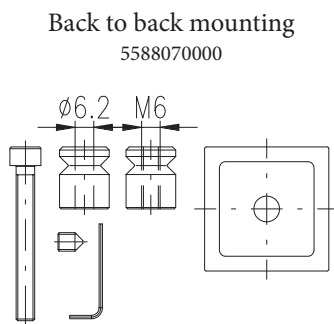
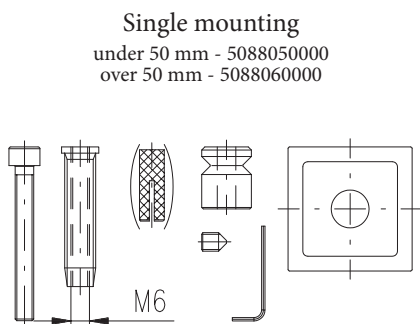

Available in stainless steel satin or in RAL variant acc. the sample book (page 47)

PULL HANDLES

PULL HANDLE GAMA - stainless steel satin

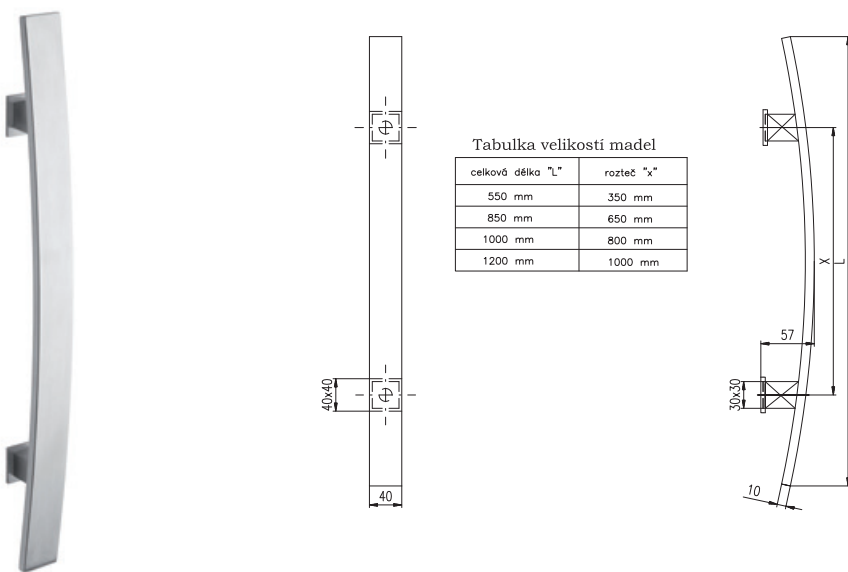

Tabulka velikosti model

celková délka "L"	rozteč "x"
550 mm	350 mm
850 mm	650 mm
1000 mm	800 mm
1200 mm	1000 mm

Door pull is designed to be mounted on the door using screws M6. Suitable for outdoor use. Assembly material depends on mounting options below and it is not included. Available in stainless steel satin or in RAL variant acc. the sample book (page 47).

Single mounting

under 50 mm - 5088100000
over 50 mm - 5088110000

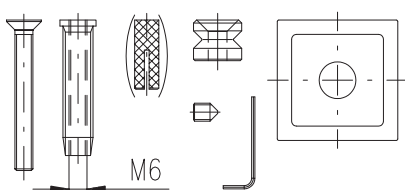

Back to back mounting

5588120000

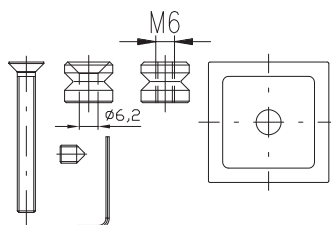

Single mounting – glass door

5588130000

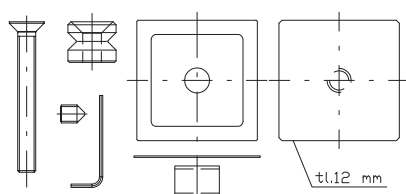

Back to back mounting – glass door

5588140000

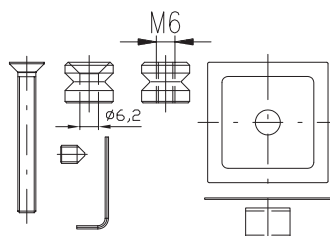

Available in stainless steel satin or in RAL variant acc. the sample book (page 47)

PULL HANDLE DELTA - stainless steel satin

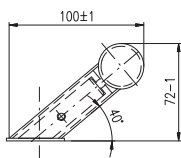

Tabulka velikostí model

celková délka "L"	rozteč "x"
300 mm	200 mm
400 mm	300 mm
500 mm	300 mm
600 mm	400 mm
800 mm	600 mm
1000 mm	700 mm
1200 mm	900 mm
1800 mm	1400 mm

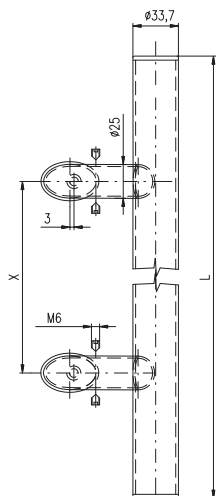

Door pull is designed to be mounted on the door using screws M6. Suitable for outdoor use. Assembly material depends on mounting options below and it is not included. Available in stainless steel satin or in RAL variant acc. the sample book (page 47).

Single mounting

under 50 mm - 5088200000
over 50 mm - 5088210000

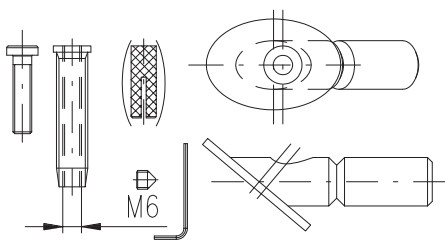

Back to back mounting

5588220000

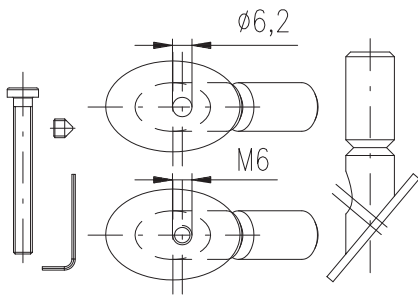

Available in stainless steel satin or in RAL variant acc. the sample book (page 47)

PULL HANDLES

PULL HANDLE OMEGA - stainless steel satin



Tabulka velikostí model

celková délka "L"	rozteč "x"
400 mm	300 mm
600 mm	400 mm
800 mm	600 mm
1000 mm	700 mm
1200 mm	900 mm
1800 mm	1400 mm

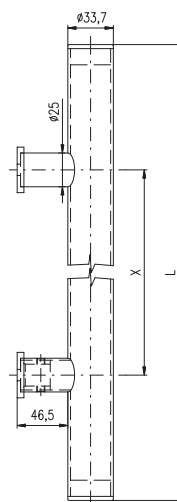

Door pull is designed to be mounted on the door using screws M6. Suitable for outdoor use. Assembly material depends on mounting options below nad it is not included. Available in stainless steel satin or in RAL variant acc. the sample book (page 47).

Single mounting

under 50 mm - 5088150000
over 50 mm - 5088160000

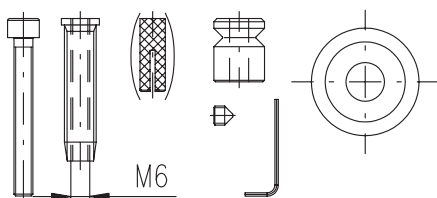

Back to back mounting

5588170000

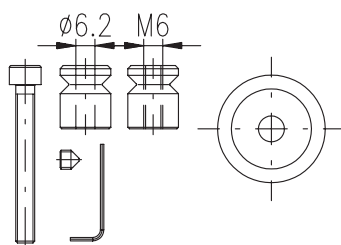

Single mounting – glass door

5588180000

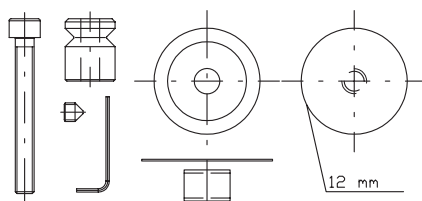

Back to back mounting – glass door

5588190000

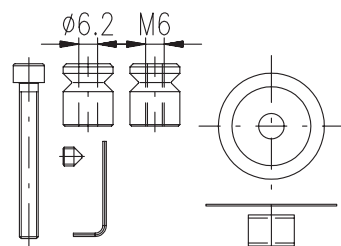

Available in stainless steel satin or in RAL variant acc. the sample book (page 47)

PANIC FITTING

Compatible with wide range of panic mortise locks. Possibility of using on escape route acc. EN179

850 BORA/8 included split spindle – with reversible mechanism

handle-handle

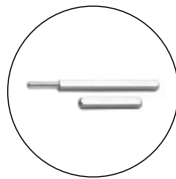

DIN EN 179



Variant: left, right

Pitch: 72 mm, 92 mm

Door thickness: 40-75 mm

Included split spindle 8x8 and spindle reduction 9x9 mm (reduction 10x10 mm on request), two reversible mechanism if handle-handle option

Stainless steel satin

850 BORA/5 included split spindle

handle-handle

handle-knob

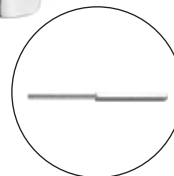
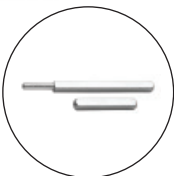

DIN EN 179



Variant: left, right

Pitch: 72 mm, 92 mm

Door thickness: 55-75 mm

Included split spindle 8x8 (spindle reduction 9x9 and 10x10 mm on request), without reversible mechanism

Handle-handle, handle-knob

Stainless steel satin

SECURITY FITTING RX PANIK

BK RX802-40 PANIK stainless steel satin

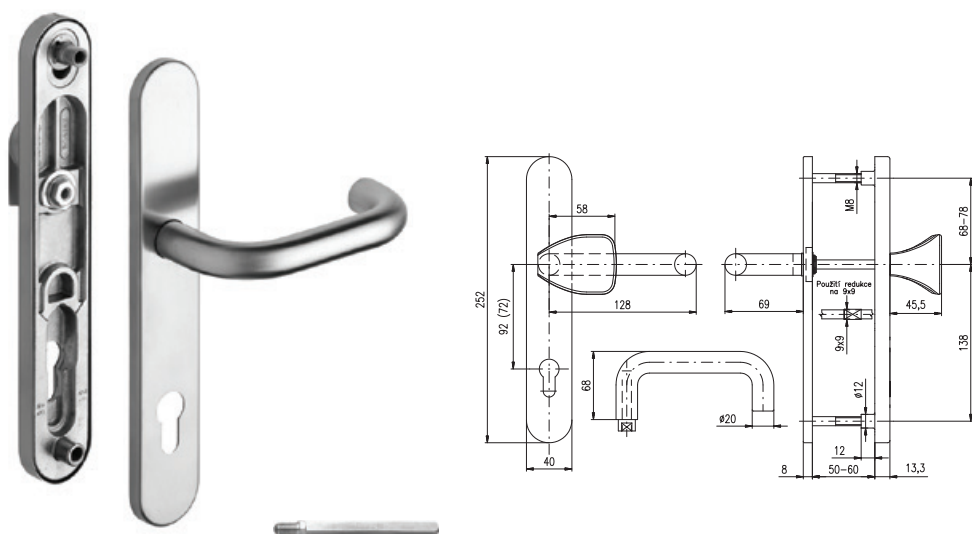

Pitch: 72,90, 92 mm

Door thickness: 50-60 mm

Compatible with wide range of panic mortise locks. Suitable for escape routes acc. to EN179. With square spindle 8x8 mm, included spindle reduction 9x9mm (10x10 on request). Lever handle-knob one spring, handle-handle two springs. Set is working only on the doors opening outside.

Note: State the orientation of lever handle L or R. Displayed set is pointing to the right.



BK RX807-40 PANIK stainless steel satin



Handle-handle two springs
Square spindle 8x8 mm



SECURITY FITTING GRANDE – PANIK

BK 807 GRANDE - PANIK stainless steel satin

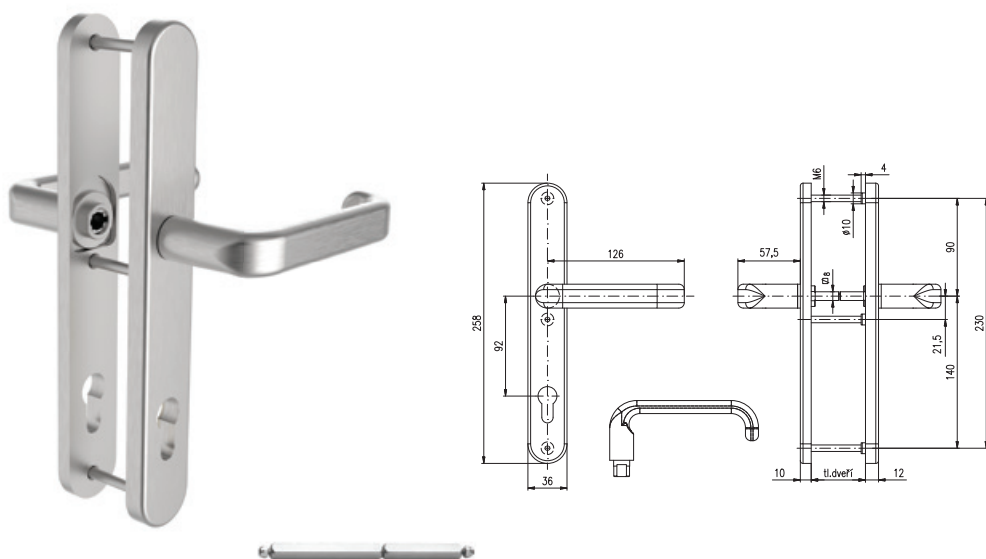

Pitch: 92 mm

Door thickness: 50-60 mm

Compatible with wide range of mortise locks. Suitable for escape routes acc to EN 179. High durability, tested to 200 000 cycles. Each handle is firmly attached to the plate. With square spindle 8x8 mm, included spindle reduction 9x9 mm (10x10 mm on request). Spring loaded handles on both sides.

Variant: right, left



SECURITY FITTING GRANDE

BK 802 GRANDE stainless steel satin

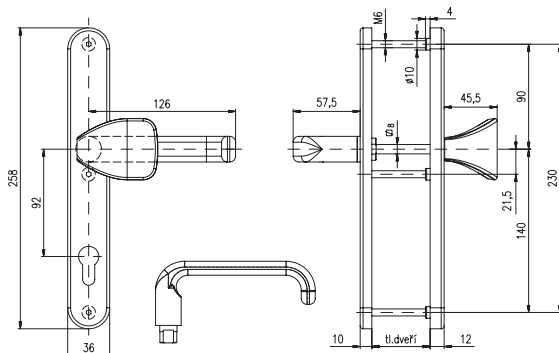

Pitch: 72, 90 mm

Door thickness: 40-50 mm

Compatible with wide range of mortise locks. High durability, tested to 200 000 cycles. Reversible spring for handle (variant handle-handle: spring loaded handles on both sides).

Variant: right, left



BK 807 GRANDE stainless steel satin



IMPORTANT DESIGN PARAMETERS RN

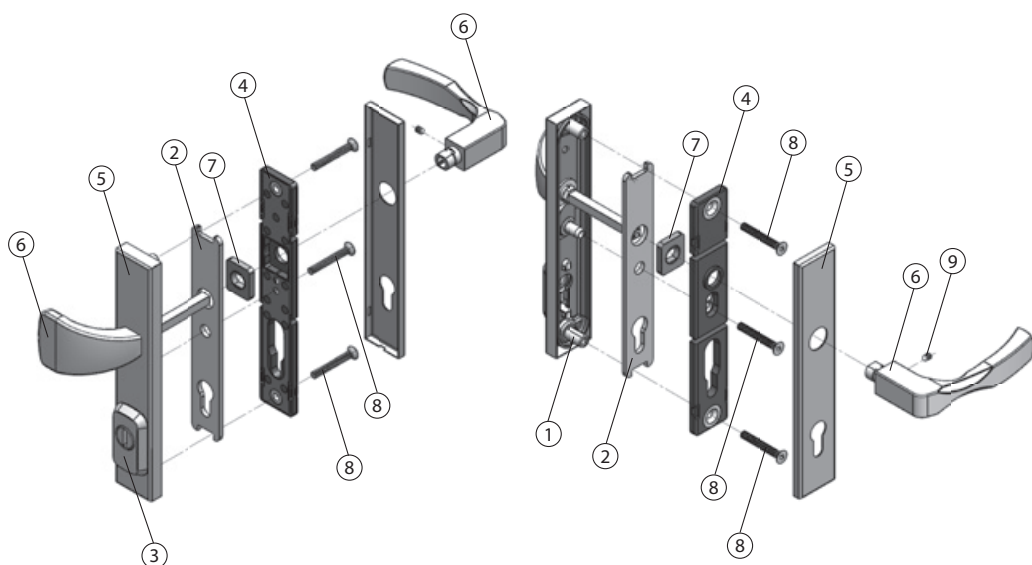

1. **Security back plate** — steel plate with three bolts
2. **Covering plate** — additional steel plate hardened 52 HRC
3. **Cylinder protector** — made from stainless steel casting with drilling resistant ring, hardened up to min. 50 HRC
4. **Inner plate with steel body**
5. **Front and outer shields made from stainless steel with resistant surface treatment**
6. **Stainless steel lever handle and knob**
7. **Reversible mechanism**
8. **Connecting through screws M6** class 8.8 provide a tight and resistant connection of the backplates
9. **Grub screw for lever handle fixing**



Security fittings ROSTEX conforms to the requirements of EN 1906 standard for a usage in burglary resistant doors. The design of the security fittings ROSTEX meets the test parameters prescribed within the standard and fulfill security demands of the resistant class 3

SECURITY FITTINGS RN

BK RN1 FONDI stainless steel satin

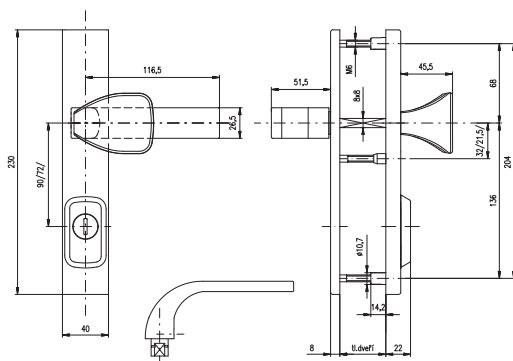

Pitch: 72, 90, 92 mm

Door thickness: 38-50 mm

For thicker door, see the fastening material on page 45. Cylinder must not protrude above the door surface more than 15,5 mm.



BK RN4 FONDI
stainless steel satin



BK RN802 FONDI
stainless steel satin



BK RN807 FONDI
stainless steel satin



BK RN1 FONDI
black (RAL 9005)



KNOB LUMINO
 stainless steel satin



KNOB LUMINO
 black (RAL 9005)



BK RN1 MANDELO stainless steel satin

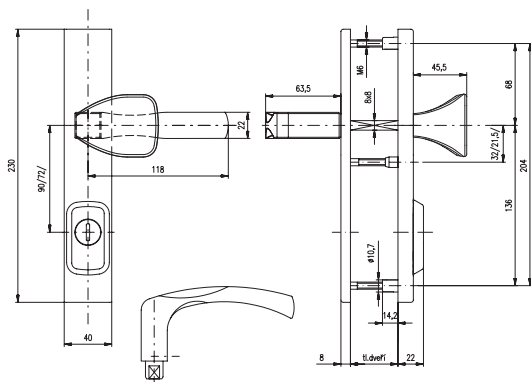

Pitch: 72, 90, 92 mm

Door thickness: 38-50 mm

For thicker door, see the fastening material on page 45.

Cylinder must not protrude above the door surface more than 15,5 mm



BK RN4
MANDELO
stainless steel satin



BK RN802
MANDELO
stainless steel satin



BK RN807
MANDELO
stainless steel satin



KNOB LUMINO
 stainless steel satin



IMPORTANT DESIGN PARAMETERS RX

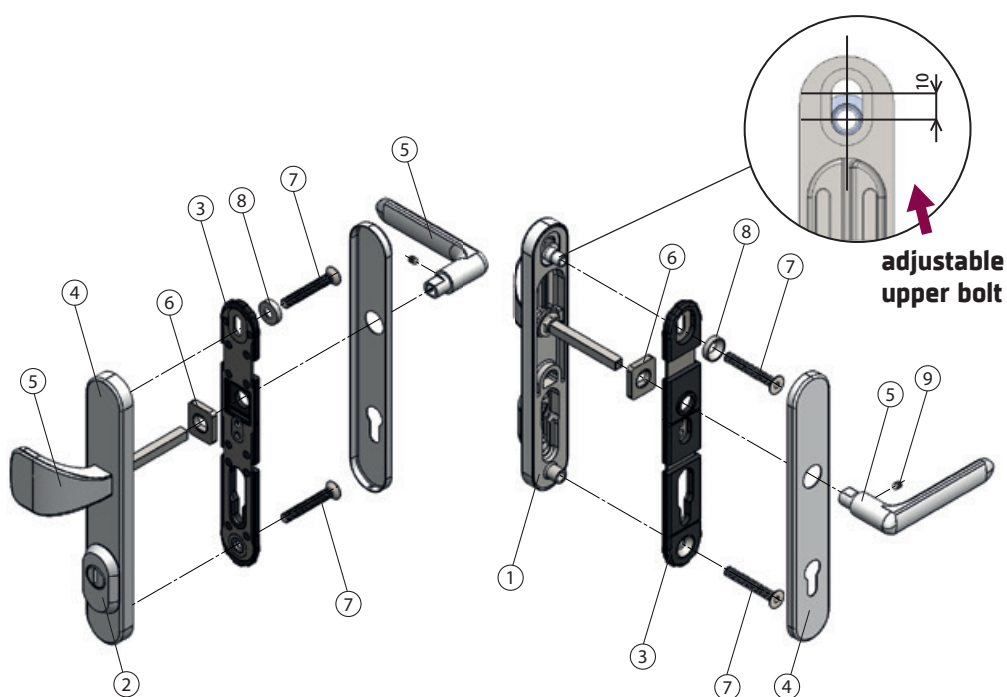

ADJUSTABLE UPPER BOLT ENABLES SHIFTING ITS POSITION FROM THE RANGE 68-78 MM

1. **Security backplate of the front shield with adjustable bolt** – massive steel casting
2. **Cylinder protector** made from stainless steel casting with drilling resistant ring, hardened up to min. 50 HRC
3. **Inner plate with steel body**
4. **Front and outer shields made from stainless steel with resistant surface treatment**
5. **Handles and knobs are made either from stainless steel or zinc alloy galvanic treatment, resistant to external environment**
6. **Reversible mechanism**
7. **High strenght bolts M8 class 8.8.**, provide a tight and resistant connection of the backplates
8. **Shaped washer of the upper bolt**
9. **Grub screw for lever handle fixing**



Security fittings ROSTEX conforms to the requirements of EN 1906 standard for a usage in burglary resistant doors. The design of the security fittings ROSTEX meet the test parameters prescribed within the standard and fulfill the strict security demands of resistant class 3 or 4

RX1-50 SOLID stainless steel satin

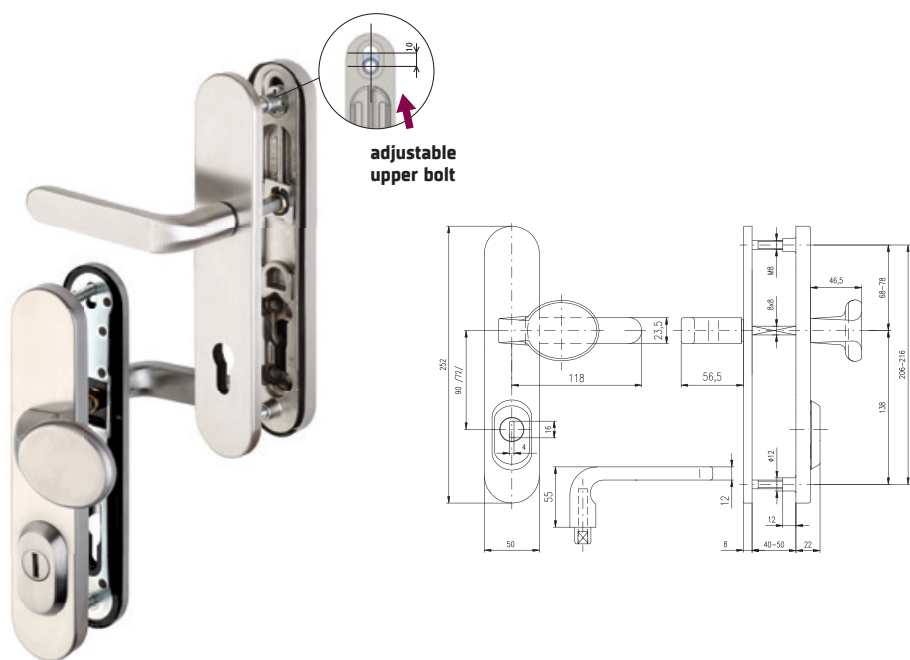

Pitch: 72, 90, 92 mm

Door thickness: 40-50 mm

For thicker door, see the fastening material on page 45.

Cylinder must not protrude above the door surface more than 15,5 mm



RX4-50 SOLID
stainless steel satin



RX802-50 SOLID
stainless steel satin



RX807-50 SOLID
stainless steel satin



SECURITY FITTINGS RX

RX1-50 EXCLUSIVE stainless steel satin, stainless steel polished

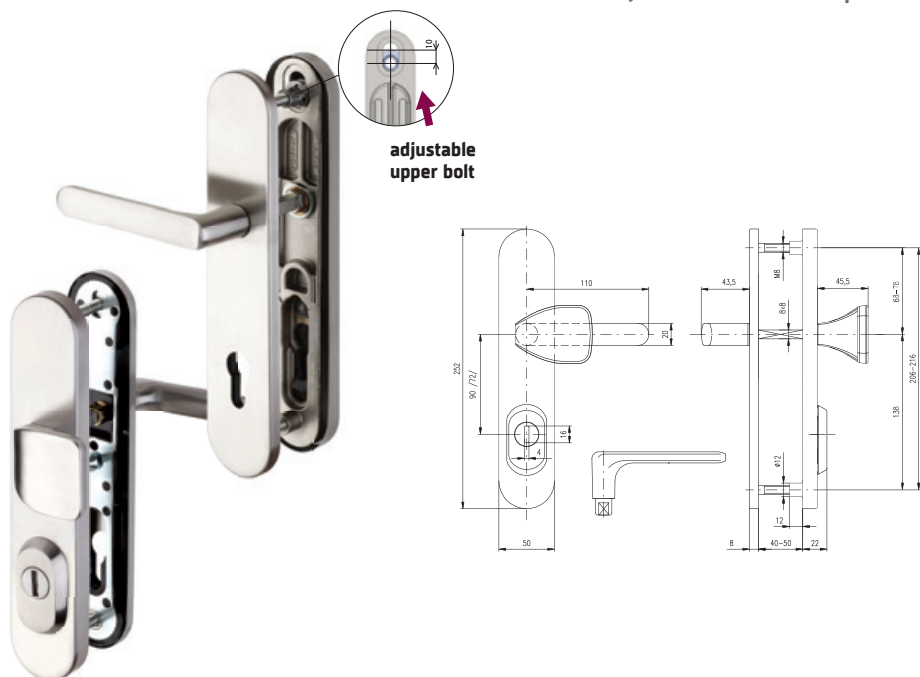

Pitch: 72, 90, 92 mm

Door thickness: 40-50 mm

For thicker door, see the fastening material on page 45.

Cylinder must not protrude above the door surface more than 15,5 mm



RX4-50 EXCLUSIVE
stainless steel satin
stainless steel polished

RX802-50 EXCLUSIVE
stainless steel satin
stainless steel polished

RX807-50 EXCLUSIVE
stainless steel satin
stainless steel polished



KNOB LUMINO



RX1 ASTRA stainless steel satin, stainless steel polished

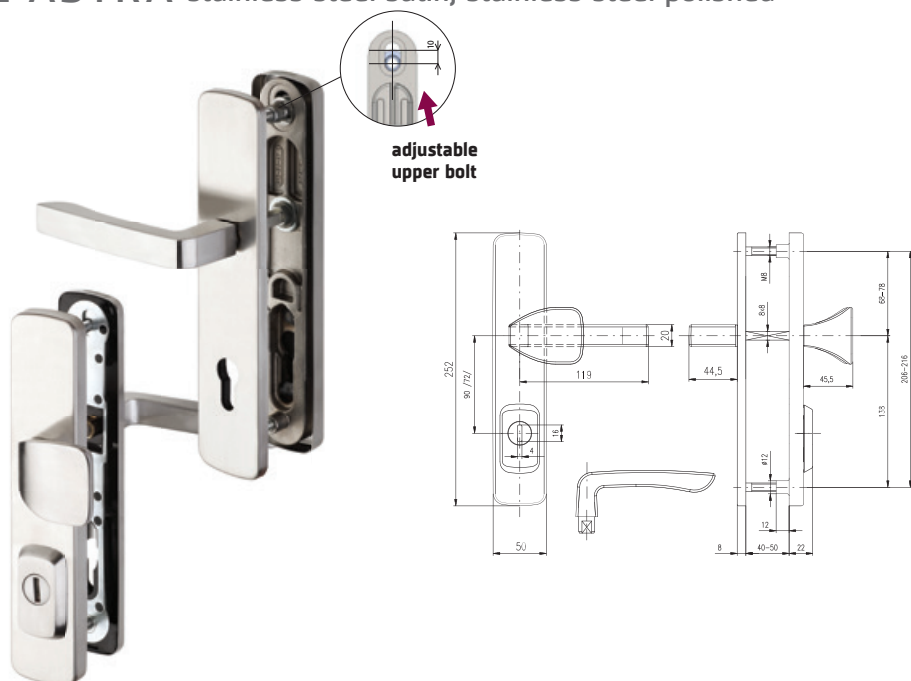

Pitch: 72, 90, 92 mm

Door thickness: 40-50 mm

For thicker door, see the fastening material on page 45.

Cylinder must not protrude above the door surface more than 15,5 mm



RX4 ASTRA

stainless steel satin
stainless steel polished



RX802 ASTRA

stainless steel satin
stainless steel polished



RX807 ASTRA

stainless steel satin
stainless steel polished



KNOB LUMINO



SECURITY FITTINGS RX ROSETTE

RX1/H RAVENA stainless steel satin

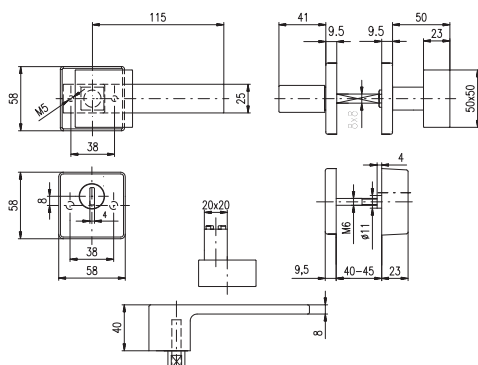

Door thickness: 40-45 mm

Fastening material: page 45

Cylinder must not protrude above the door surface more than 17 mm



RX4/H RAVENA
stainless steel satin



BK RX1/H RAVENA
black (RAL 9005)

SECURITY FITTINGS RX ROSETTE

RX1/H TREVISO stainless steel satin

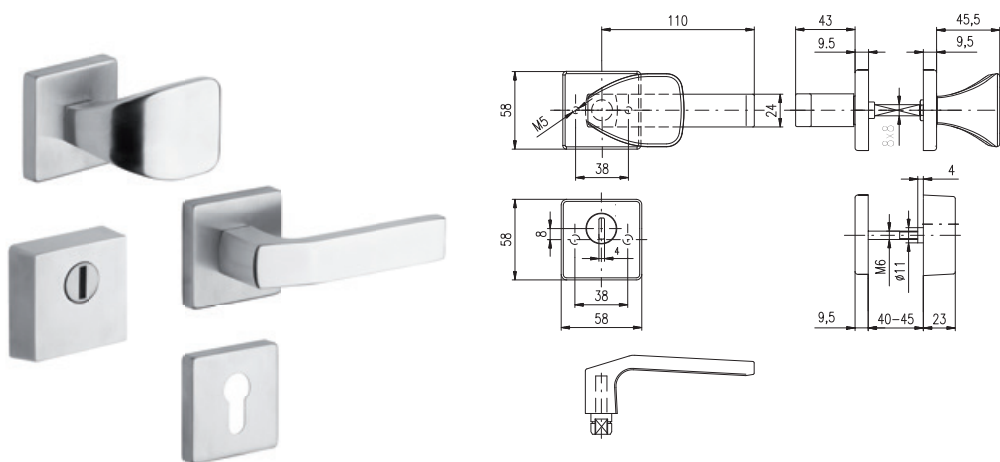

Door thickness: 40-45 mm

Fastening material: page 45

Cylinder must not protrude above the door surface more than 17 mm



RX4/H TREVISIO
stainless steel satin



KNOB LUMINO
 stainless steel satin

SECURITY FITTINGS RX ROSETTE

RX1/S EXCLUSIVE stainless steel satin

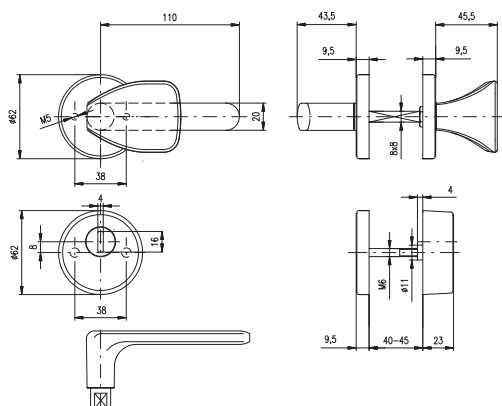

Door thickness: 40-45 mm

Fastening material: page 45

Cylinder must not protrude above the door surface more than 17 mm



RX4/S EXCLUSIVE stainless steel satin



KNOB LUMINO stainless steel satin

IMPORTANT DESIGN PARAMETERS R

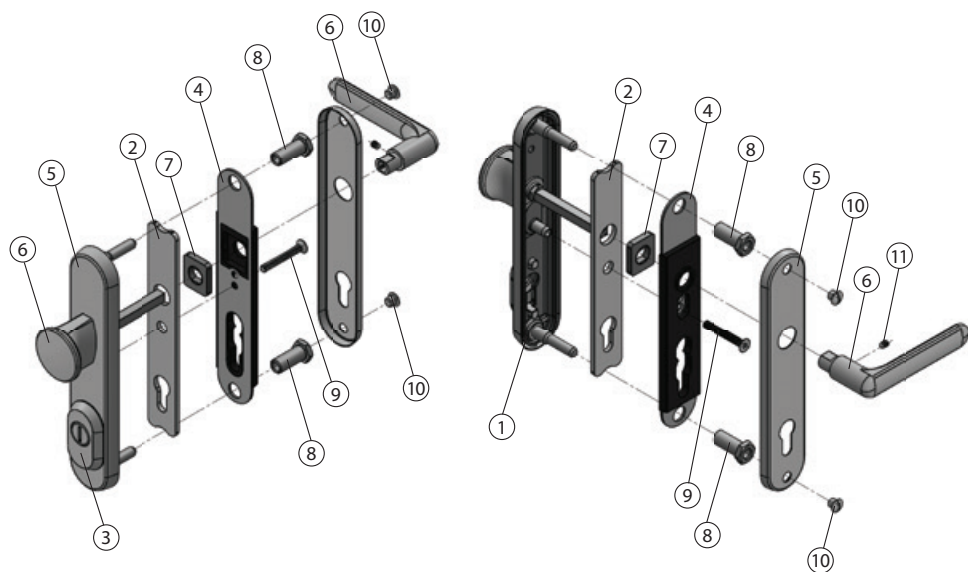

1. **Outer shield on the plate**
2. **Steel backplate** – th. 4 mm, hardened up to 52 HRC
3. **Cylinder protector** made from stainless steel casting with drilling resistant ring, hardened up to min. 50 HRC
4. **Inner plate with steel body**
5. **Inner shield made of stainless steel or brass with galvanic plating**
6. **Handles and knobs are made either from stainless steel or zinc alloy** with galvanic treatment, resistant to external environment
7. **Reversible mechanism**
8. **Connection bolts**
9. **Middle screw M6, class 8.8.**, provides a tight and resistant connection of the backplates
10. **Cover screws**
11. **Grub screw for lever handle fixing**



Security fittings ROSTEX conforms to the requirements of EN 1906 standard for a usage in burglary resistant doors. The design of security fittings ROSTEX meets the test parameters prescribed within the standard and fulfill the strict demands of security class 3 or 4

R1 stainless steel polished

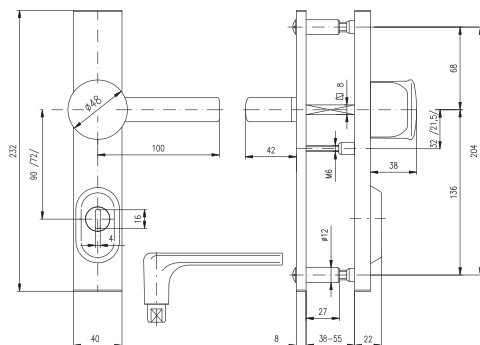

Pitch: 72, 90 mm

Door thickness: 38-55 mm

Fastening material: page 45

Model handle-knob is also possible. Cylinder must not protrude above the door surface more than 15,5 mm



R4
stainless steel
polished



802
stainless steel
polished



807
stainless steel
polished



R1/O EXCLUSIVE stainless steel satin

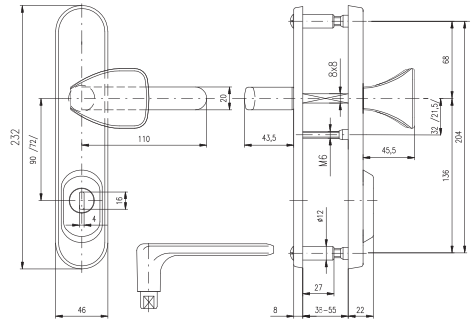

Pitch: 72, 90 mm

Door thickness: 38-55 mm

Fastening material: page 45

Model handle-knob is also possible. Cylinder must not protrude above the door surface more than 15,5 mm



R4/O EXCLUSIVE
stainless steel satin
stainless steel polished



802/O EXCLUSIVE
stainless steel satin
stainless steel polished



807/O EXCLUSIVE
stainless steel satin
stainless steel polished



SECURITY FITTINGS R

R1/O BRIT stainless steel satin

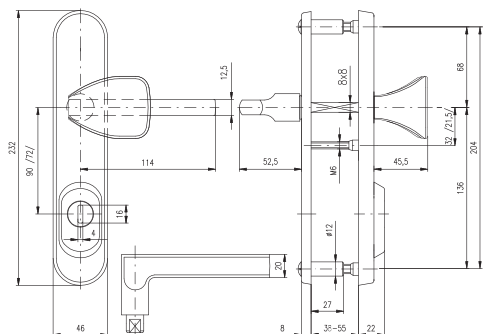

Pitch: 72, 90 mm

Door thickness: 38-55 mm

Fastening material: page 45

Cylinder must not protrude above the door surface more than 15,5 mm



R4/O BRIT
stainless steel satin



802/O BRIT
stainless steel satin



807/O BRIT
stainless steel satin



R1 ASTRA stainless steel satin, stainless steel polished

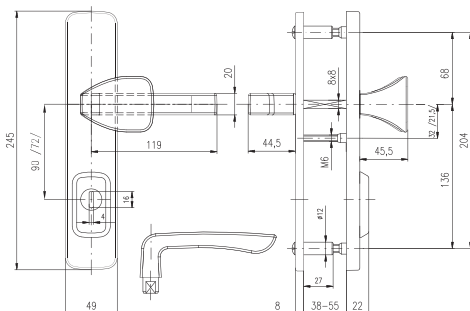

Pitch: 72, 90 mm

Door thickness: 38-55 mm

Fastening material: page 45

Cylinder must not protrude above the door surface more than 15,5 mm



R4 ASTRA

stainless steel satin
stainless steel polished



802 ASTRA

stainless steel satin
stainless steel polished



807 ASTRA

stainless steel satin
stainless steel polished



SECURITY FITTING ALUMINIUM

BK EL 1 ELOX – silver

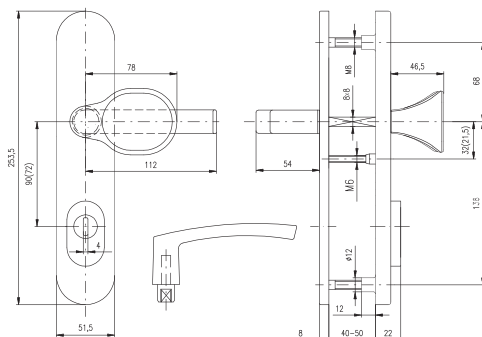

Pitch: 72, 90, 92 mm

Door thickness: 40-50 mm, (66-75mm)

Fastening material: page 45

Aluminium security fitting with steel lockplate and hidden screws.

Cylinder must not protrude above the door surface more than 16 mm



BK EL 4



BK EL 1 BARYT
black (RAL 9005)

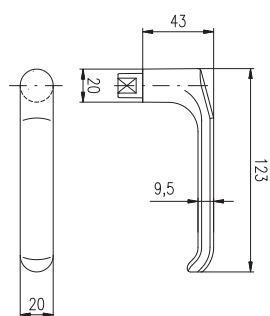

FASTENING MATERIAL

BK 802, R1

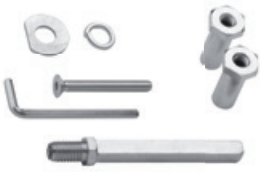

Fastenning material for 802, R1 door thickness 38-55 mm - standard. For 802, R1 door thickness 56-70 mm. Further extensions per 15 mm up to 100 mm

BK 807, R4

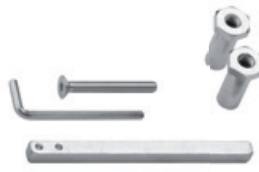

BK RX802, RX1



Fastenning material for RX807, RX4 door thickness 40-50 mm – standard. For RX807, RX4 door thickness 51-60 mm. Further extensions per 10 up to 100 mm

BK RX807, RX4



BK RX1/H, RX1/S



Fastenning material for R1/H, R1/S door thickness 46-50 mm – standard. For R1/H, R1/S door thickness 51-55 mm – further extensions per 5 up to 100 mm

BK RX4/H, RX4/S

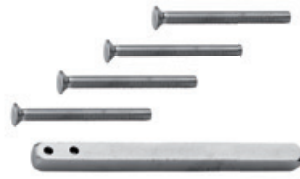

BK EL 1



Fastenning material for EL1, door thickness 40-50 mm – standard. Fastenning material for EL1, door thickness 51-60 mm/ 61-70 mm. Further extensions per 5 mm up to 100 mm.

BK EL 4



BK RN1, RN802



Fastenning material for RN1, door thickness 38-50 mm – standard. Fastenning material for RN1, door thickness 51-55 mm. Further extensions per 5 mm up to 100 mm

BK RN4, RN807



LETTER BOX stainless steel satin, stainless steel polished

For entrance doors, atypical mail boxes

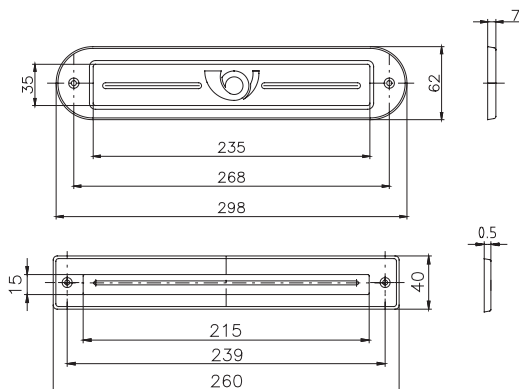

NAME PLATE ROUND

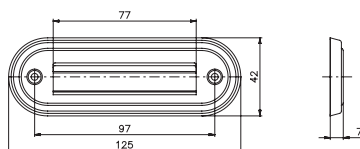

DOOR VIEWER

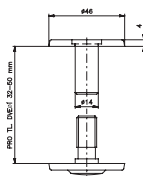

DOOR VIEWER WITH NAME PLATE OVAL

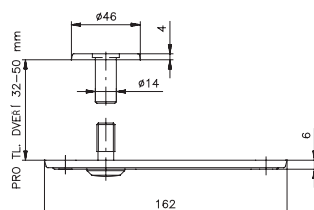
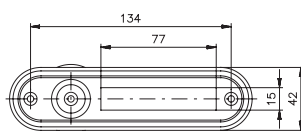



0100 STAINLESS STEEL POLISHED – STAINLESS STEEL CHROMIUM (CR)

Handles and knobs are made from zinc alloy with galvanic treatment – polished Cr

Shields, cylinder protectors and resistant rings are made from stainless steel – polished



7200 STAINLESS STEEL SATIN

Handles, knobs, shields, cylinder protectors and resistant rings are made of stainless steel – satin



8000 STAINLESS STEEL POLISHED GOLD

Titanium nitrid (TiN) applied on polished chrome or polished stainless steel finish in vacuum environment



8800 STAINLESS STEEL SATIN GOLD

Titanium nitrid (TiN) applied on stainless steel satin finish in vacuum environment



RAL 9005 black



RAL 9003 white



RAL 7016 anthracite



ROSTEX VYŠKOV, s.r.o.
Dědická 190/17
682 01 Vyškov
Czech Republic

e-mail: odbyt@rostex.cz
tel.: +420 517 316 415
www.rostex.cz